

**Low Response Score** ■ 30.1 - 42.5 ■ 25.1 - 30.0 ■ 20.1 - 25.0 ■ 15.1 - 20.0 ■ 5.7 - 15.0

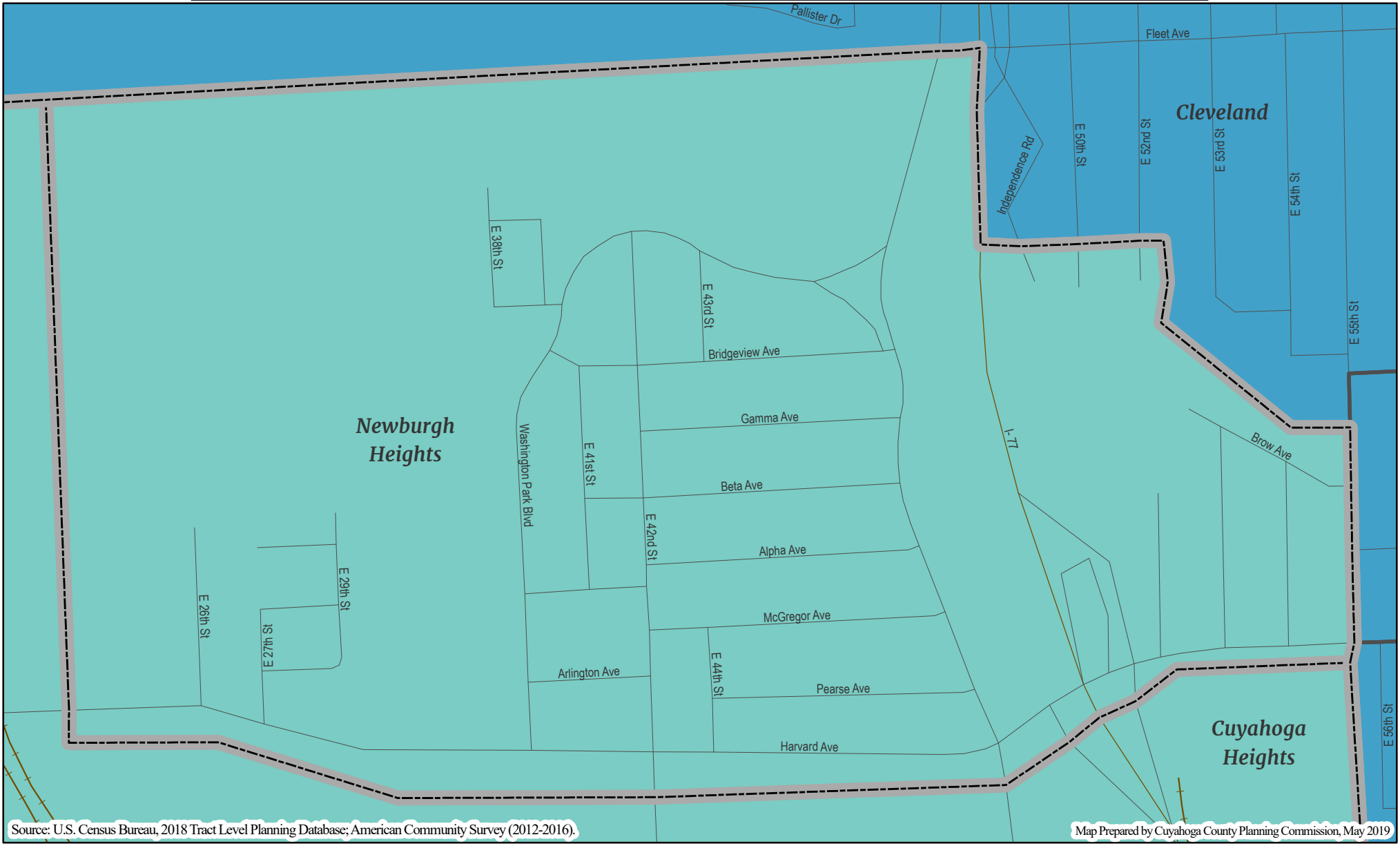

Source: U.S. Census Bureau, 2018 Tract Level Planning Database; American Community Survey (2012-2016).

Map Prepared by Cuyahoga County Planning Commission, May 2019

# 2020 Census Complete Count - Cuyahoga County

## Village of Newburgh Heights, Ohio

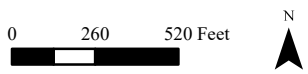

For more outreach maps visit: <http://www.countyplanning.us/2020census/>

**Percent Renter Households** ■ 100% - 75.1% ■ 75% - 50.1% ■ 50% - 25.1% ■ 25% - 0%

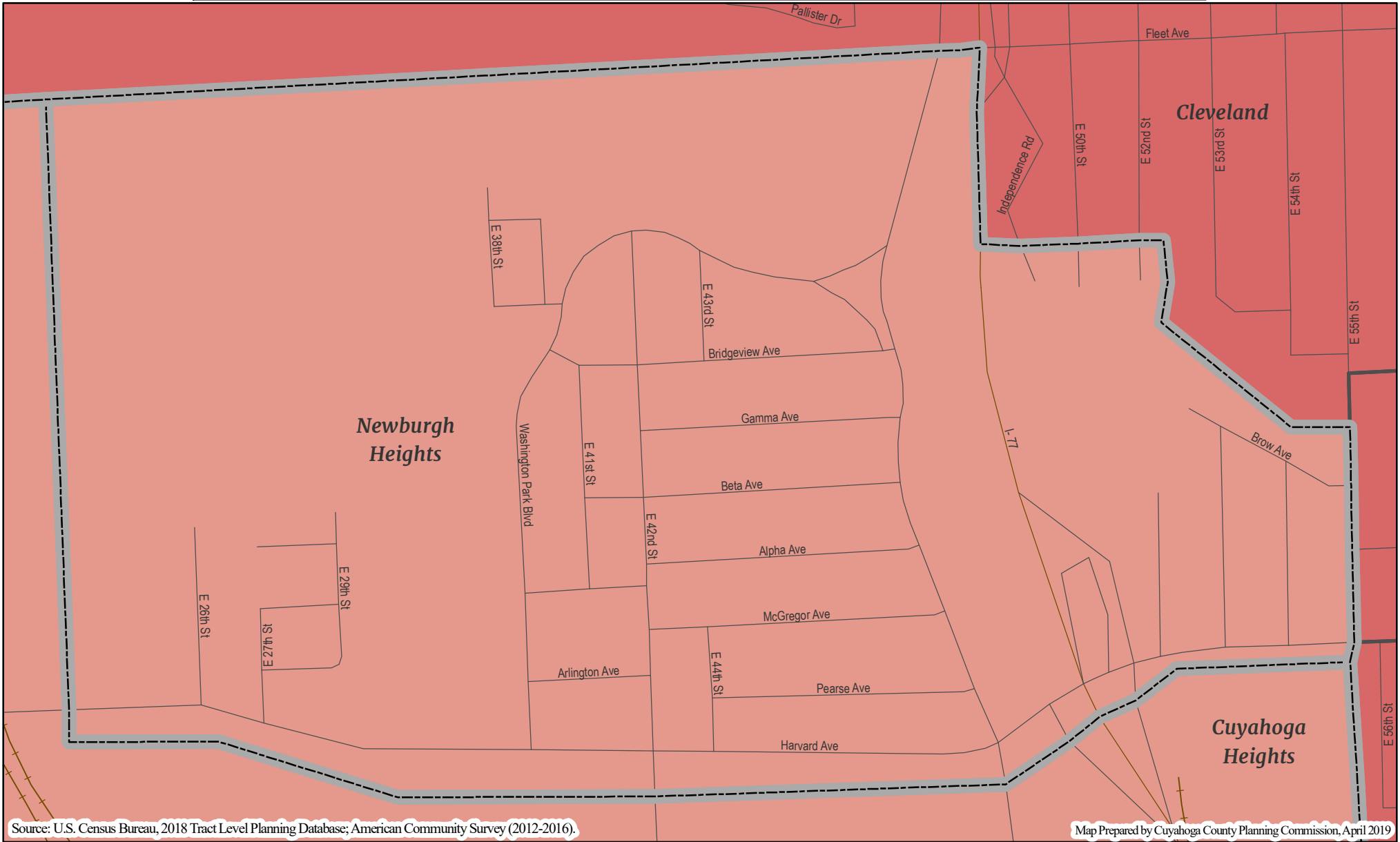

Source: U.S. Census Bureau, 2018 Tract Level Planning Database; American Community Survey (2012-2016).

Map Prepared by Cuyahoga County Planning Commission, April 2019

# 2020 Census Complete Count - Cuyahoga County

## Village of Newburgh Heights, Ohio

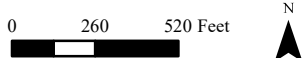

For more outreach maps visit: <http://www.countyplanning.us/2020census/>

**Percent Population Ages 18 To 24** ■ 76.9% - 30.1% ■ 30% - 10.1% ■ 10% - 5.1% ■ 5% - 0.6

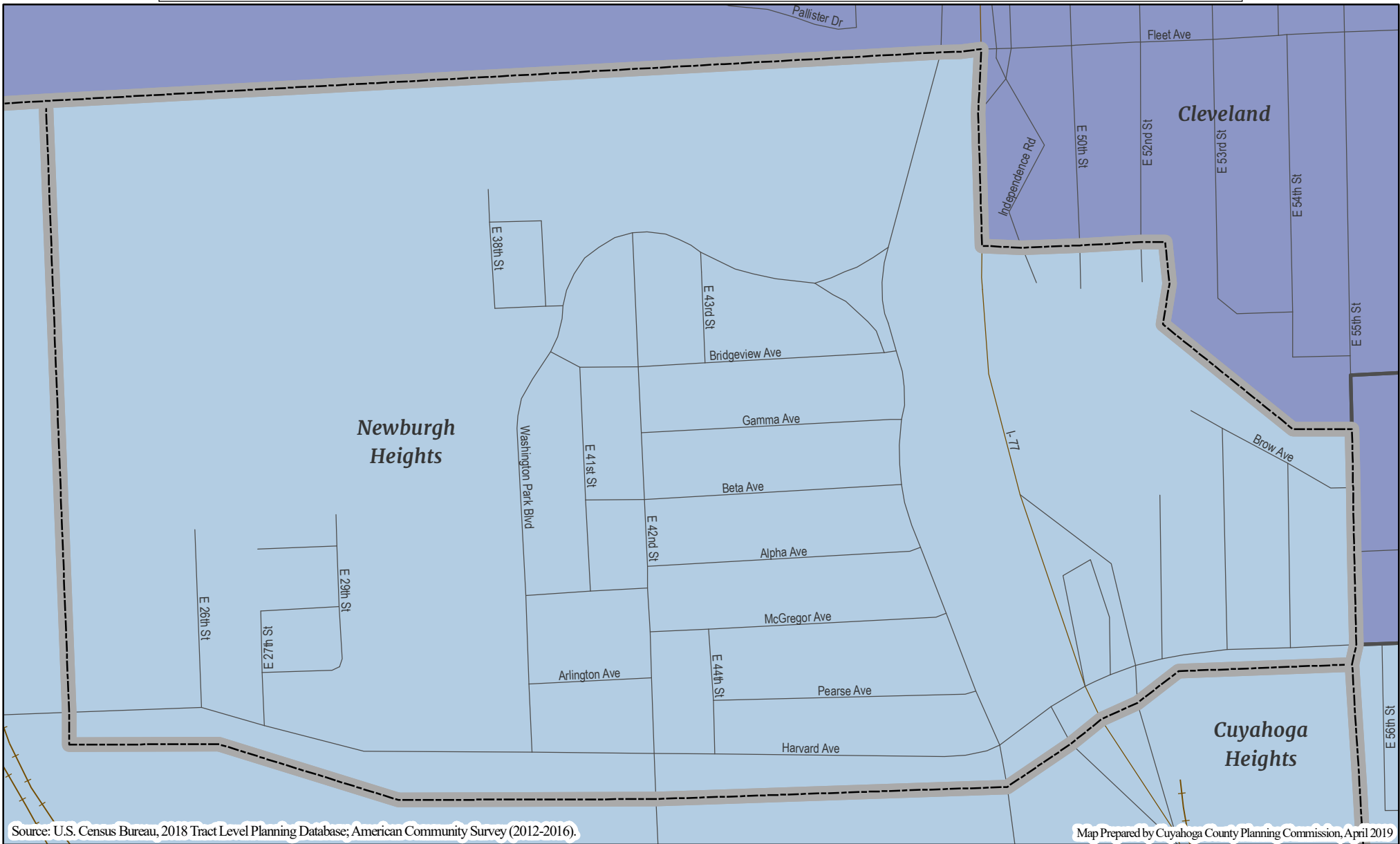

Source: U.S. Census Bureau, 2018 Tract Level Planning Database; American Community Survey (2012-2016).

Map Prepared by Cuyahoga County Planning Commission, April 2019

# 2020 Census Complete Count - Cuyahoga County

## Village of Newburgh Heights, Ohio

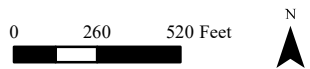

For more outreach maps visit: <http://www.countyplanning.us/2020census/>

**Percent Population Age 5 and Under** ■ 23% - 12.1% ■ 12% - 8.1% ■ 8% - 4.1% ■ 4% - 0.1%

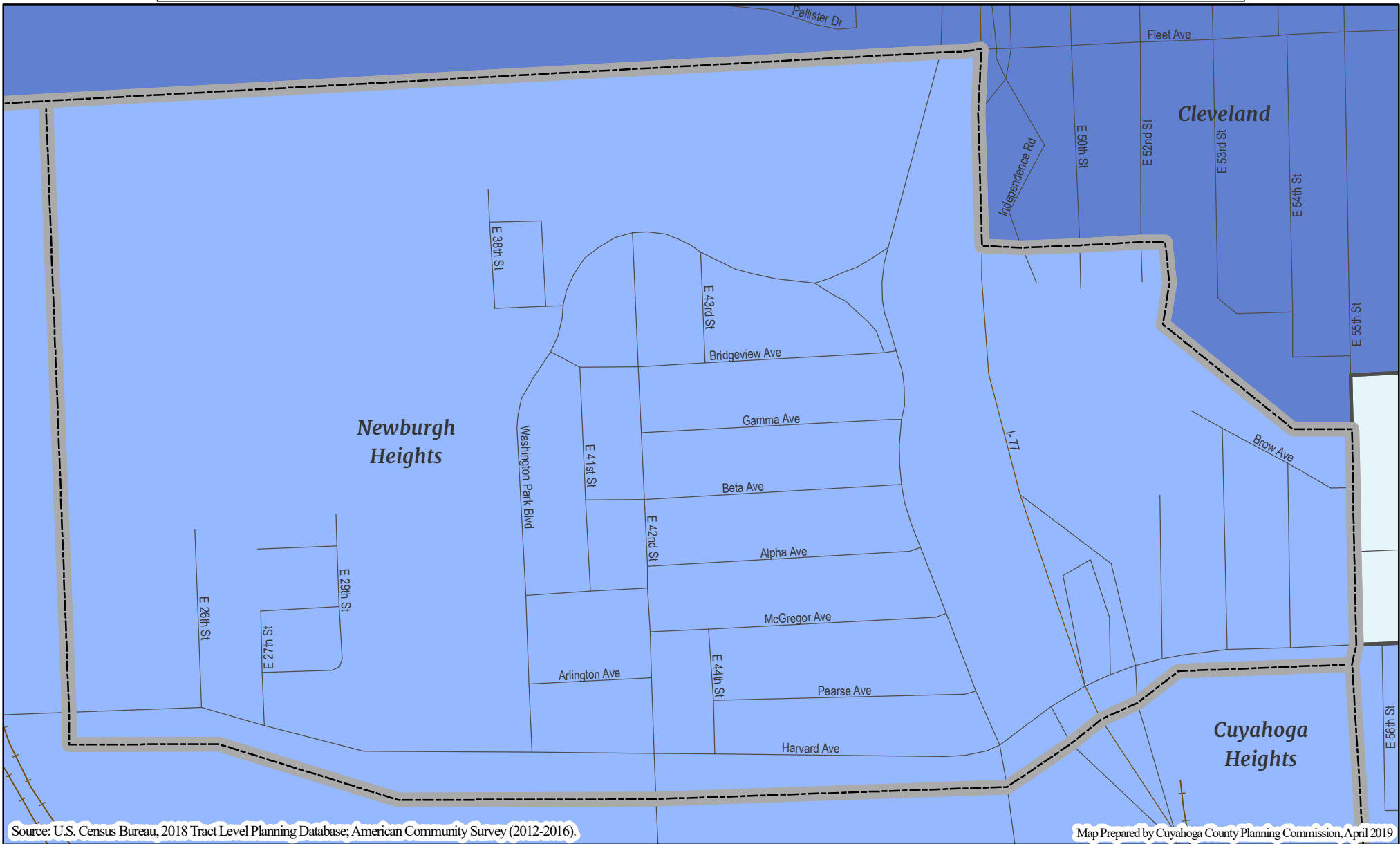

Source: U.S. Census Bureau, 2018 Tract Level Planning Database; American Community Survey (2012-2016).

Map Prepared by Cuyahoga County Planning Commission, April 2019

# 2020 Census Complete Count - Cuyahoga County

## Village of Newburgh Heights, Ohio

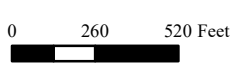

For more outreach maps visit: <http://www.countyplanning.us/2020census/>

**Percent Female Head of Household** ■ 75% - 25.1% ■ 25% - 15.1% ■ 15% - 10.1% ■ 10% - 0%

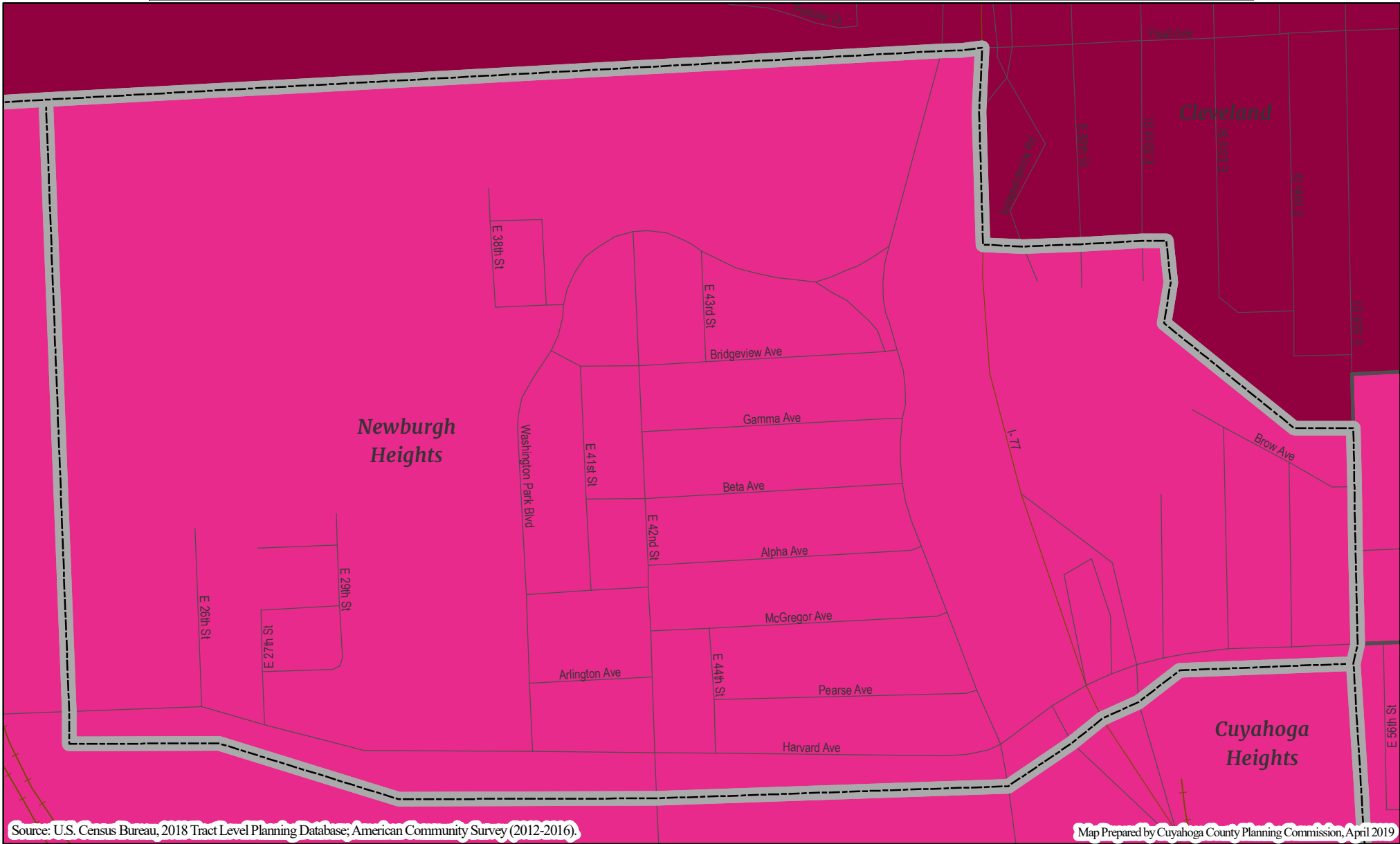

Source: U.S. Census Bureau, 2018 Tract Level Planning Database; American Community Survey (2012-2016).

Map Prepared by Cuyahoga County Planning Commission, April 2019

# 2020 Census Complete Count - Cuyahoga County

## Village of Newburgh Heights, Ohio

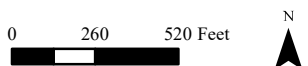

For more outreach maps visit: <http://www.countyplanning.us/2020census/>

**Percent African-American** ■ 100% - 75.1% ■ 75% - 50.1% ■ 50% - 25.1% ■ 25% - 0%

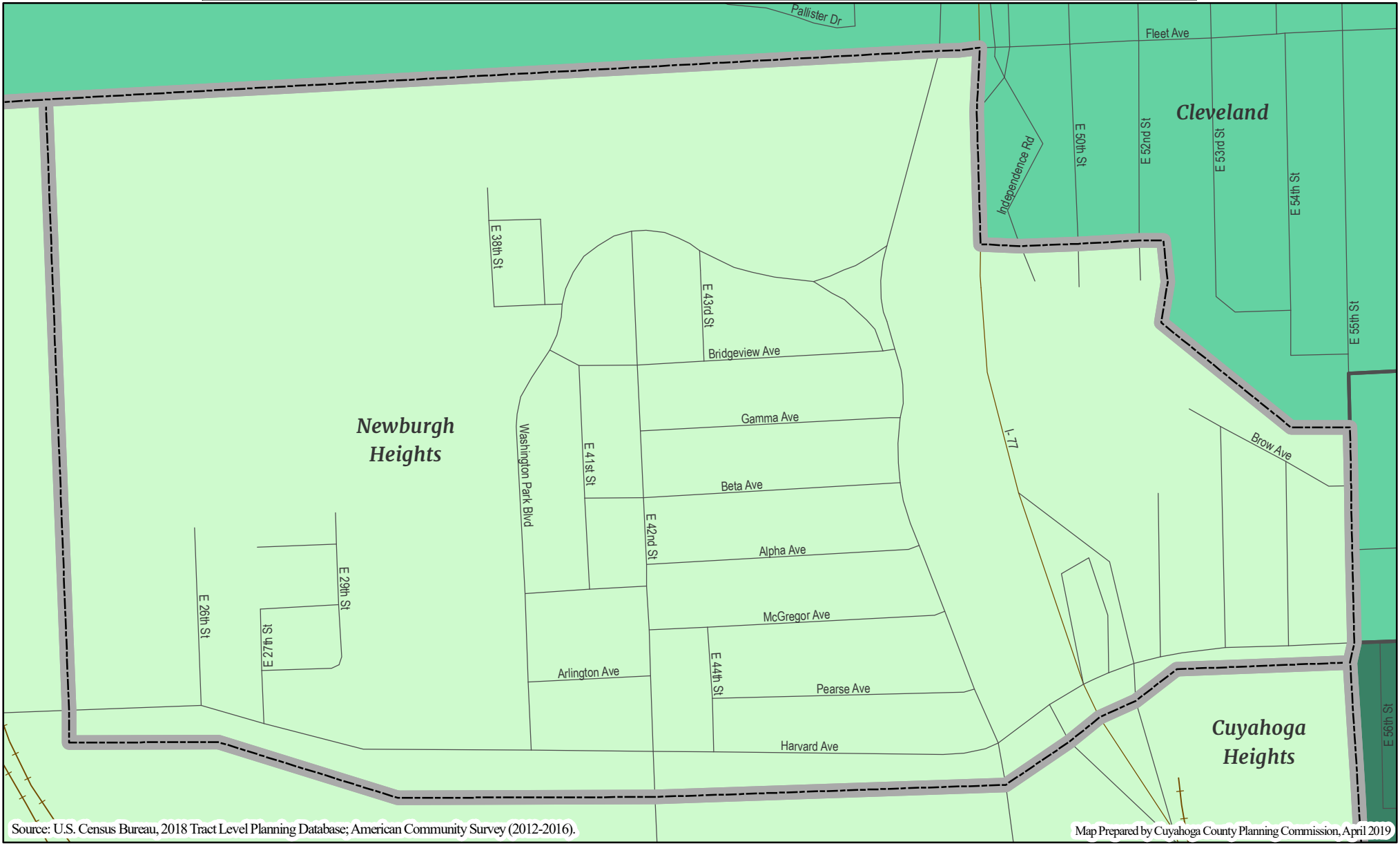

Source: U.S. Census Bureau, 2018 Tract Level Planning Database; American Community Survey (2012-2016).

Map Prepared by Cuyahoga County Planning Commission, April 2019

# 2020 Census Complete Count - Cuyahoga County

## Village of Newburgh Heights, Ohio

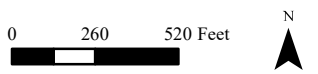

For more outreach maps visit: <http://www.countyplanning.us/2020census/>

**Percent Population With Different Housing Unit One Year Ago** ■ 67.3% - 20.1% ■ 20% - 15.1% ■ 15% - 10.1% ■ 10% - 2.2%

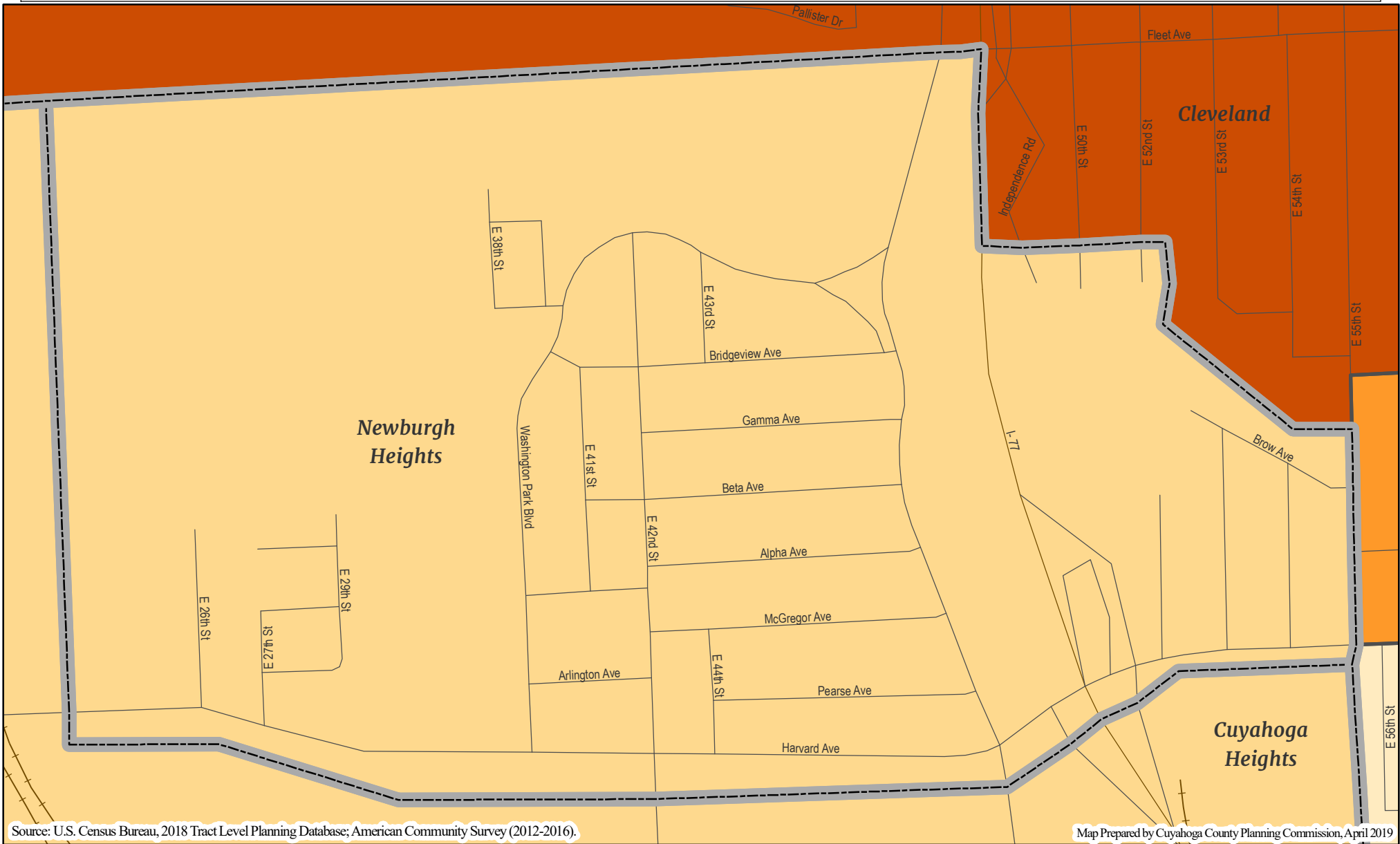

Source: U.S. Census Bureau, 2018 Tract Level Planning Database; American Community Survey (2012-2016).

Map Prepared by Cuyahoga County Planning Commission, April 2019

# 2020 Census Complete Count - Cuyahoga County

## Village of Newburgh Heights, Ohio

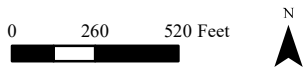

For more outreach maps visit: <http://www.countyplanning.us/2020census/>

**Percent Other Language Spoken At Home** ■ 44.6% - 25.1% ■ 25% - 10.1% ■ 10% - 5.1% ■ 5% - 0%

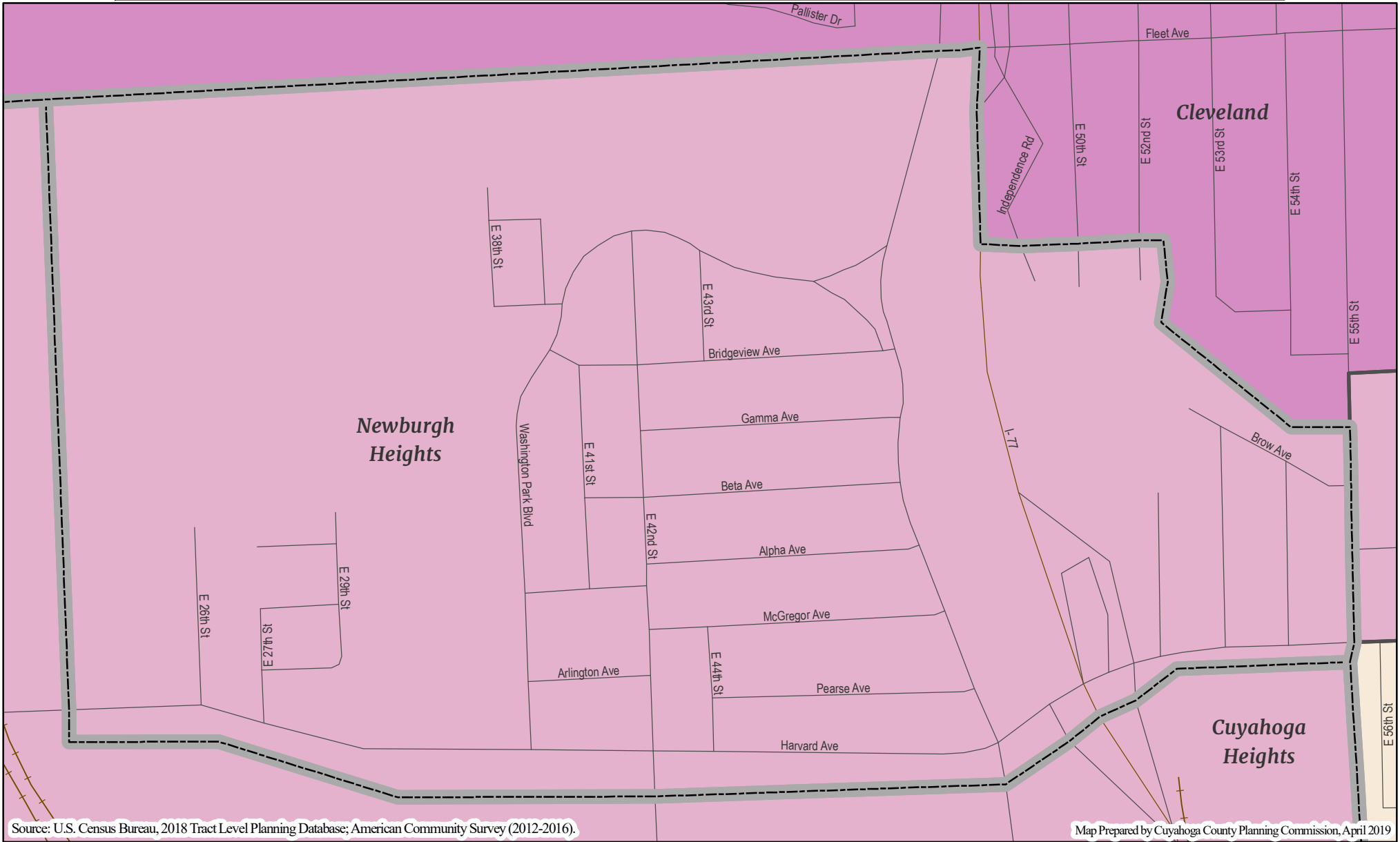

Source: U.S. Census Bureau, 2018 Tract Level Planning Database; American Community Survey (2012-2016).

Map Prepared by Cuyahoga County Planning Commission, April 2019

# 2020 Census Complete Count - Cuyahoga County

## Village of Newburgh Heights, Ohio

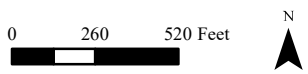

For more outreach maps visit: <http://www.countyplanning.us/2020census/>